



## Gourmet 10T Master Pro

Electrical Power Supply

CODE: 926007635

Seats	80/160
Trays	10T GN 1/1
Outside dimension	715 L x 800 P x 1000 H mm
Tray distance	65 mm
Power	16 kW
Weight	95 Kg
Max temperature	270° C
Power supply	400 V ~ 3PH + N + PE 400 V ~ 2PH + N + PE 230 V ~ 3PH + PE 230 V ~ 1PH + N + PE 50-60 Hz

### Equipment

Led illumination  
Double low emissive glass  
Blue LED for chamber cleaning check  
Core probe MultiBakePOINT  
Nine cooking modes  
Rounded baking chamber  
Automatic control of dry/steam balance inside the chamber  
Multi-timer function for multiple and mixed cooking  
Manual mode  
Automatic preheating  
Delayed cooking programming  
Automatic detection and errors report  
Fan inversion, speed control and motor brake

BakePOINT Multipoint core probe  
High-performance thermal insulation  
Water collection tray  
Set-up for BakeHIN vacuum core probe  
Automatic chimney opening BakeDRY  
Modularity  
Steam control in percentage BakeSTEAM  
  
Storage, viewing\* and exportation of cooking data (haccp)  
Preset programs mode  
Cooling program  
Cooking chamber automatic cooling  
Overlap option  
Adaptive steam pressure and chamber saturation control

BakeAIR multi-fan system  
USB connection  
Usable also with GN2/3 and GN1/2 trays  
Five fan speeds and semi-static cooking  
Program blocking with password  
CE Certificate  
Automatic control of the cooking level and load  
  
Customized programs mode  
EAC certification  
Delayed start programming  
Pre-loaded and online cookbook  
Openable inner glass for easy cleaning

### Options

BakeHIN vacuum core probe  
BakeCLEAN automatic washing system  
Left door opening

Ethernet connection and wi-fi set-up BakeNET  
Fat collection BakeFAT

Heart probe MultiBakePOINT  
Safety rinse

Gourmet 10T Master Pro

Electrical Power Supply

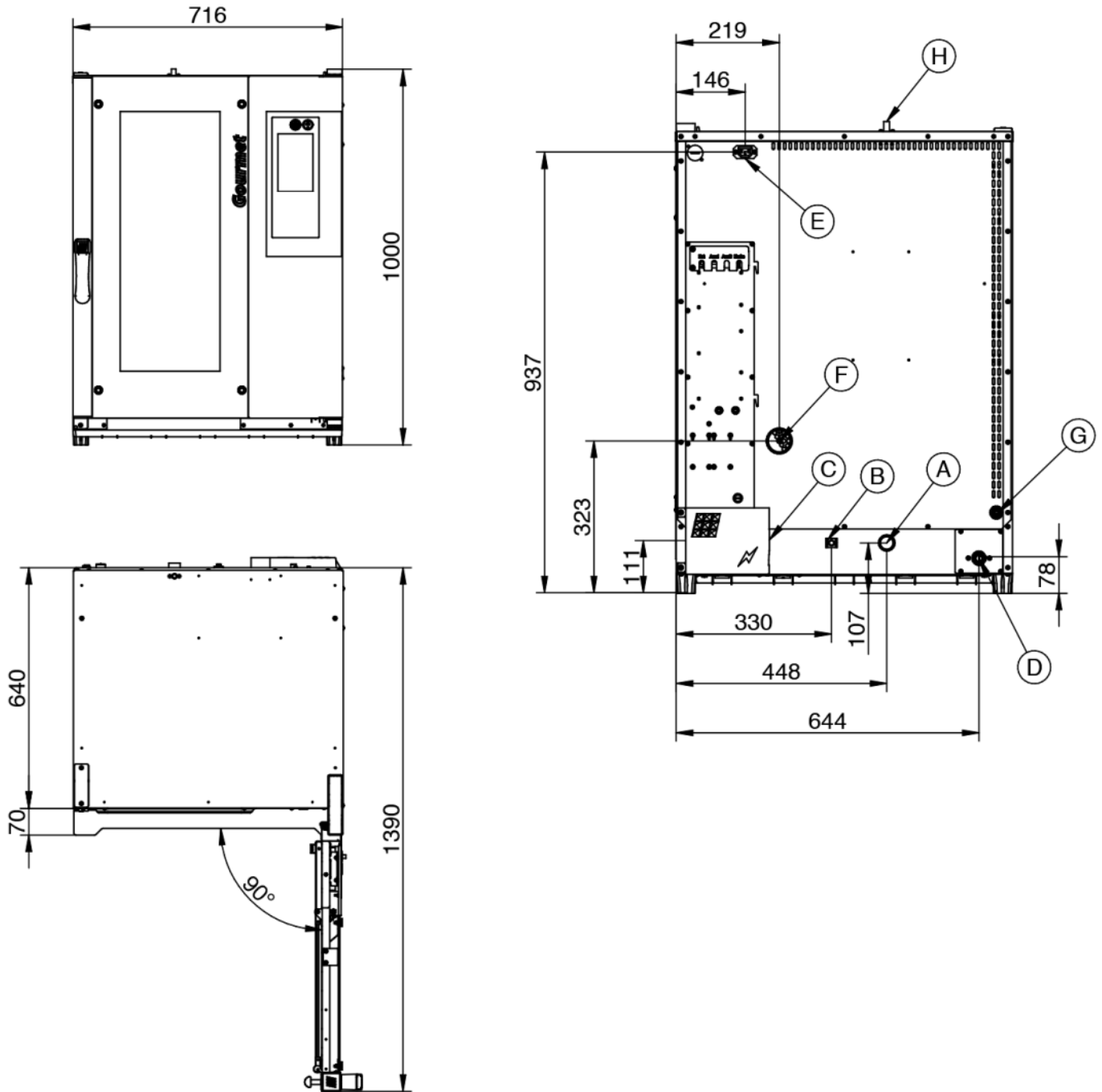

**Legend**

- A - Drain liquid Ø 30mm
- B - Equipotential terminal comb
- C - Electric supply
- D - Water inlet 3/4"
- E - Extracting hood supply
- F - Steam exhaust Ø 50mm

- G - Inlet for washing kit Ø 8mm
- H - Depressurizer Ø 12mm

**Gourmet 10T Master Pro**

Electrical Power Supply

**Supply and Connections**

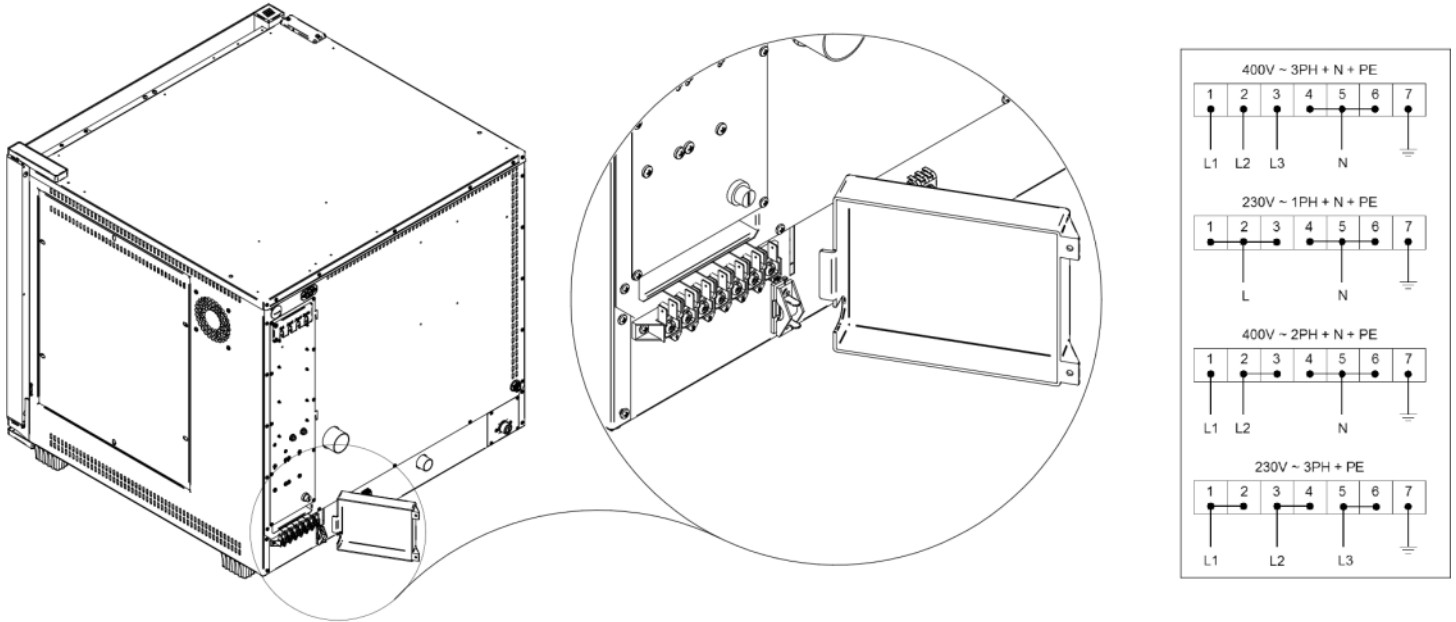

**Packaging**

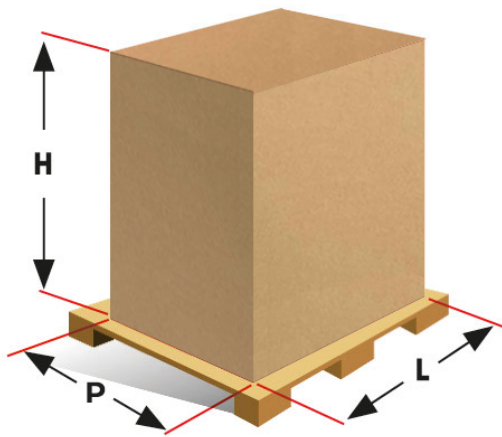

Packing size:	<b>790 L x 870 P x 1140 H mm</b>
Net weight:	<b>95 Kg</b>
Gross weight:	<b>104 Kg</b>